

NP.A13 - MOBILE BOX PROVA

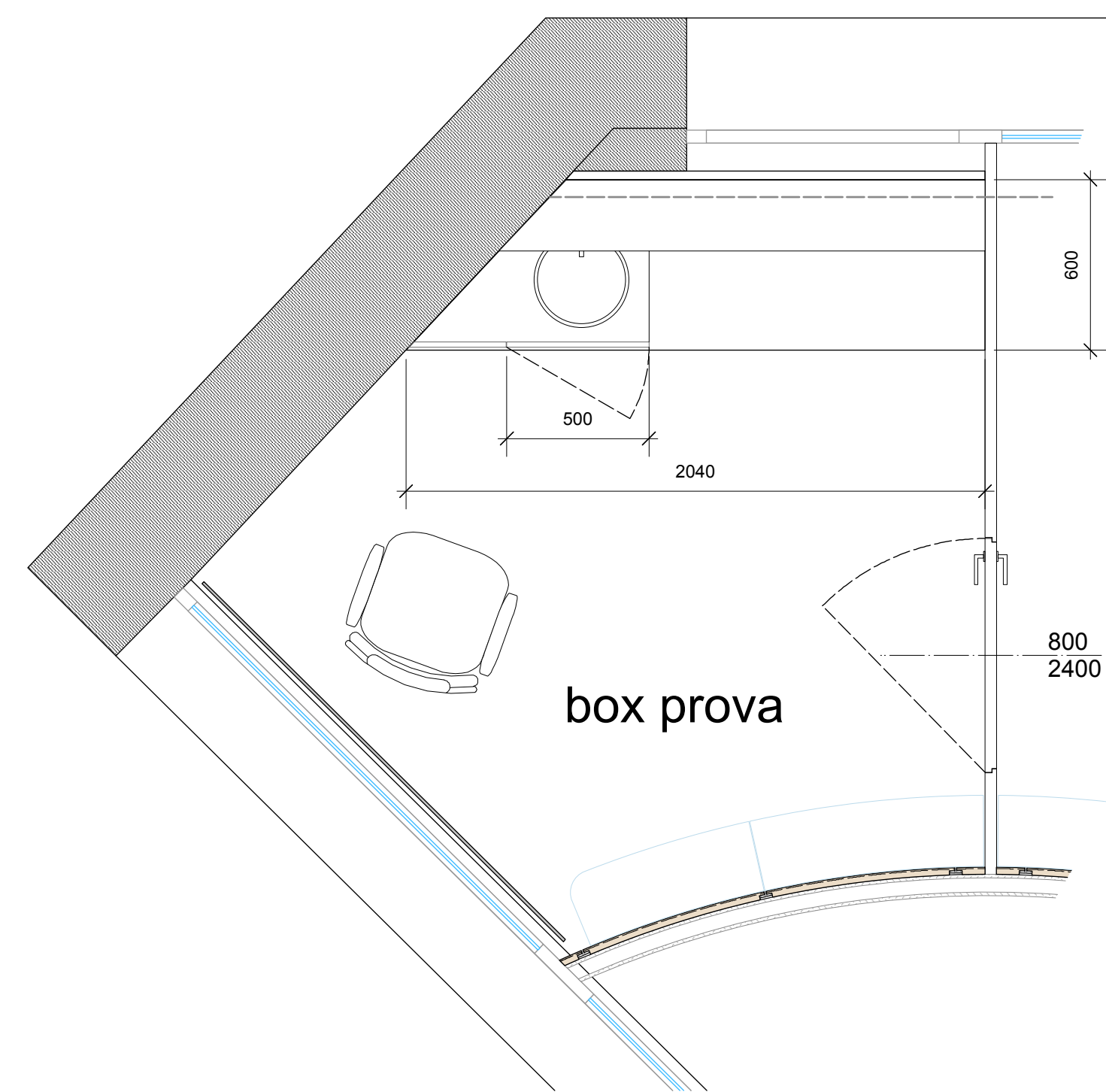

NP.A14 - MOBILE CABINA COSMESI

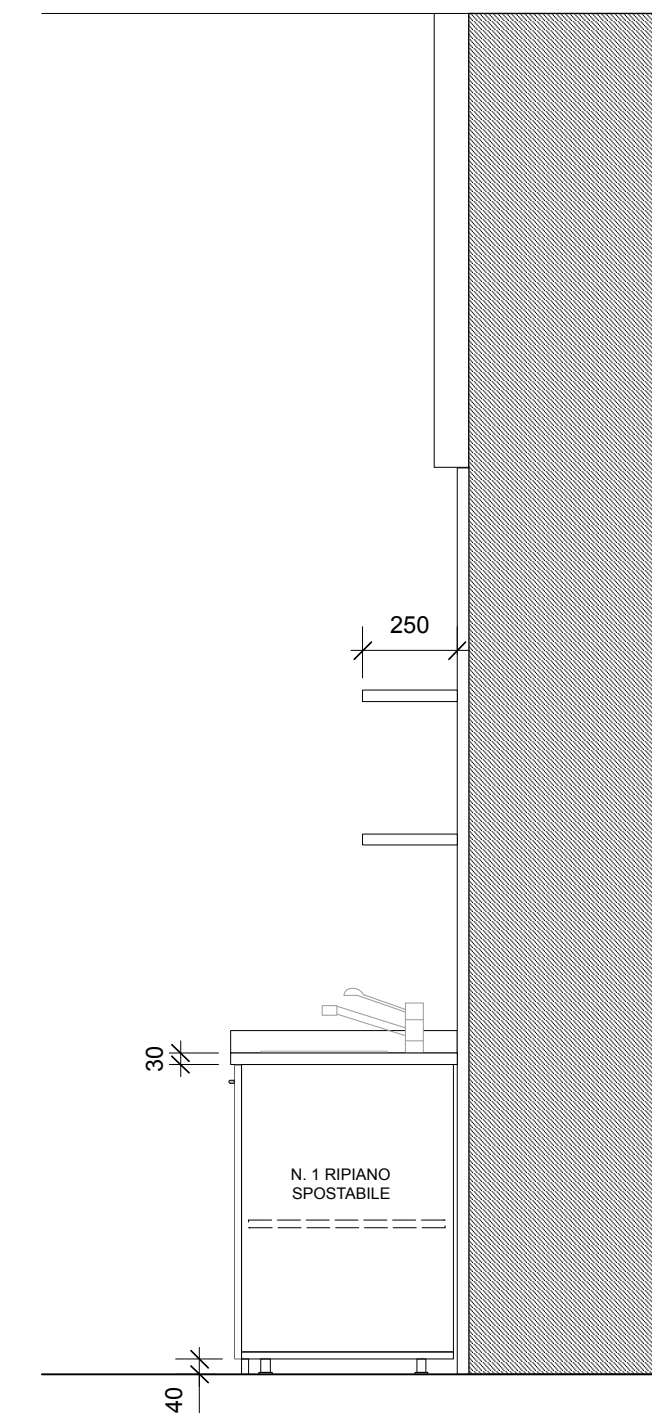
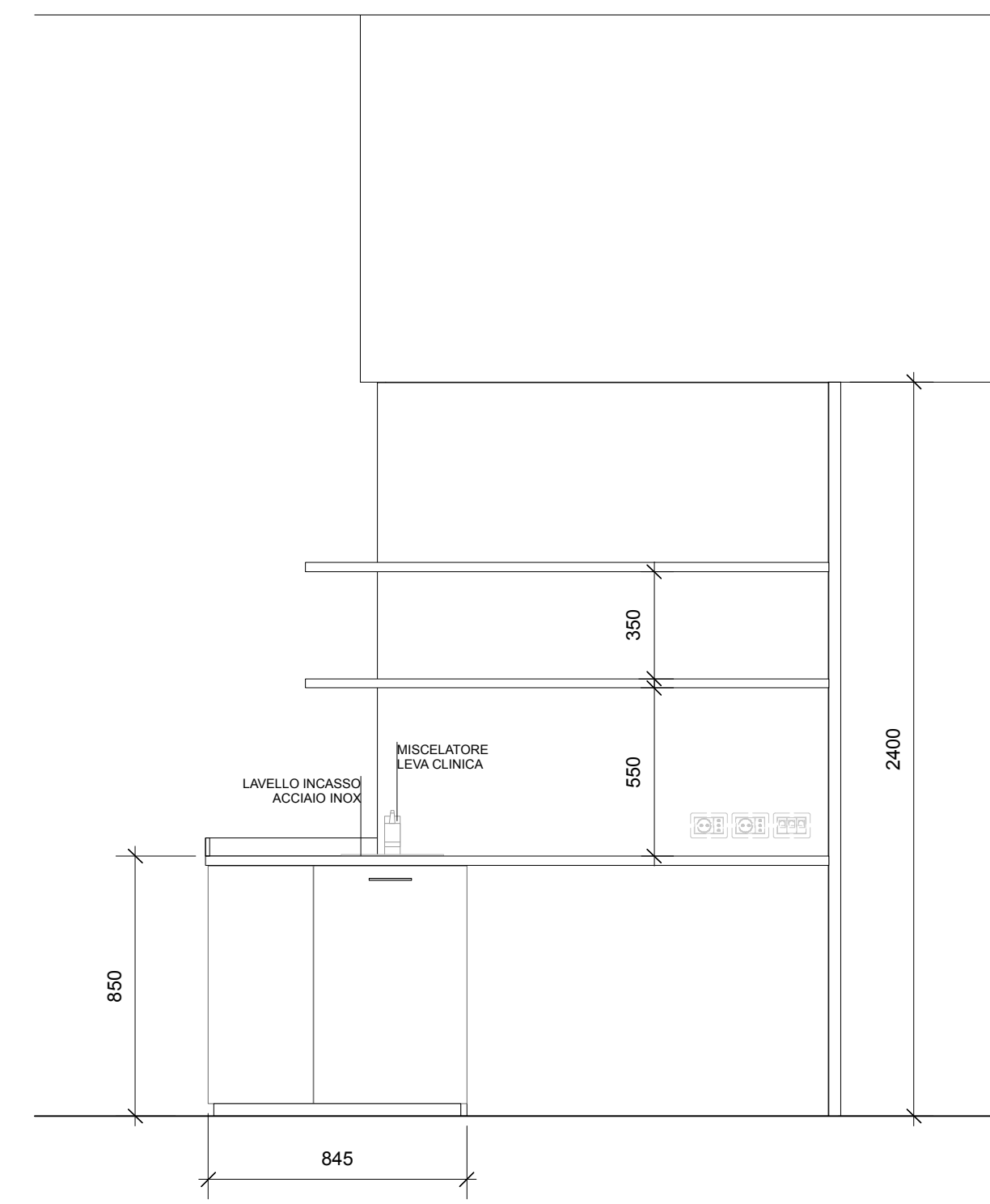
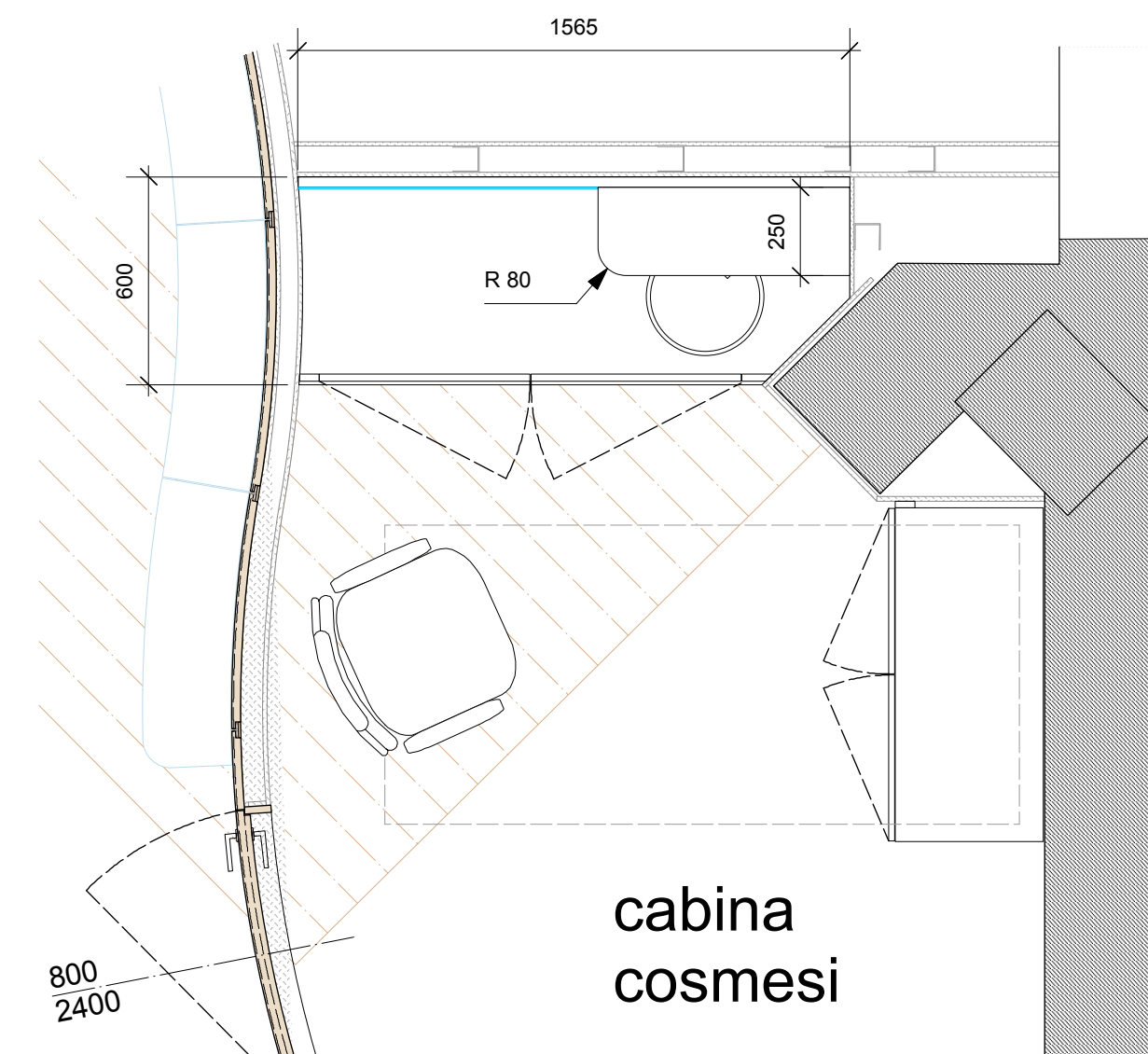
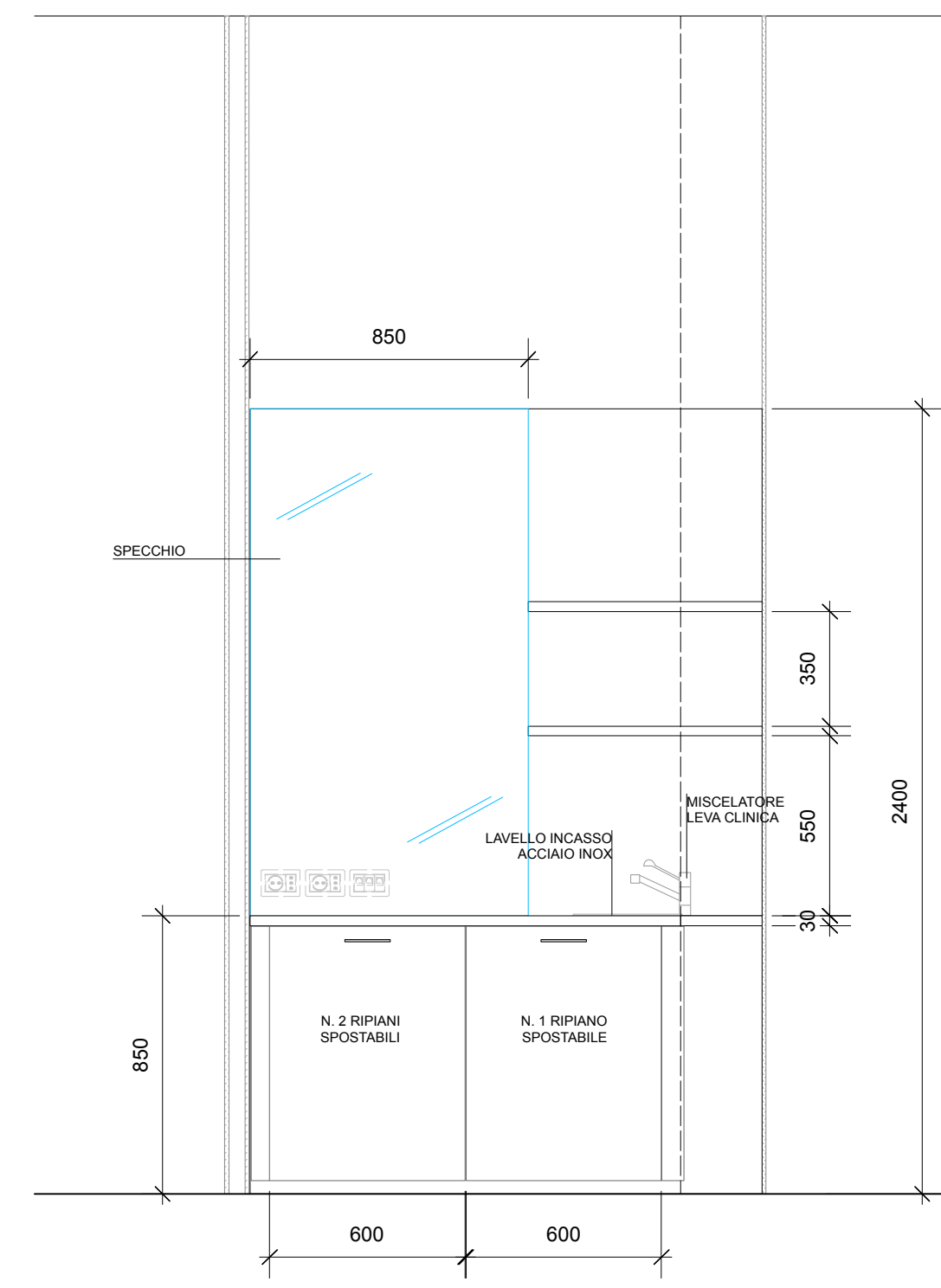

NP.A15 - MOBILE CONTENITORE LETTO

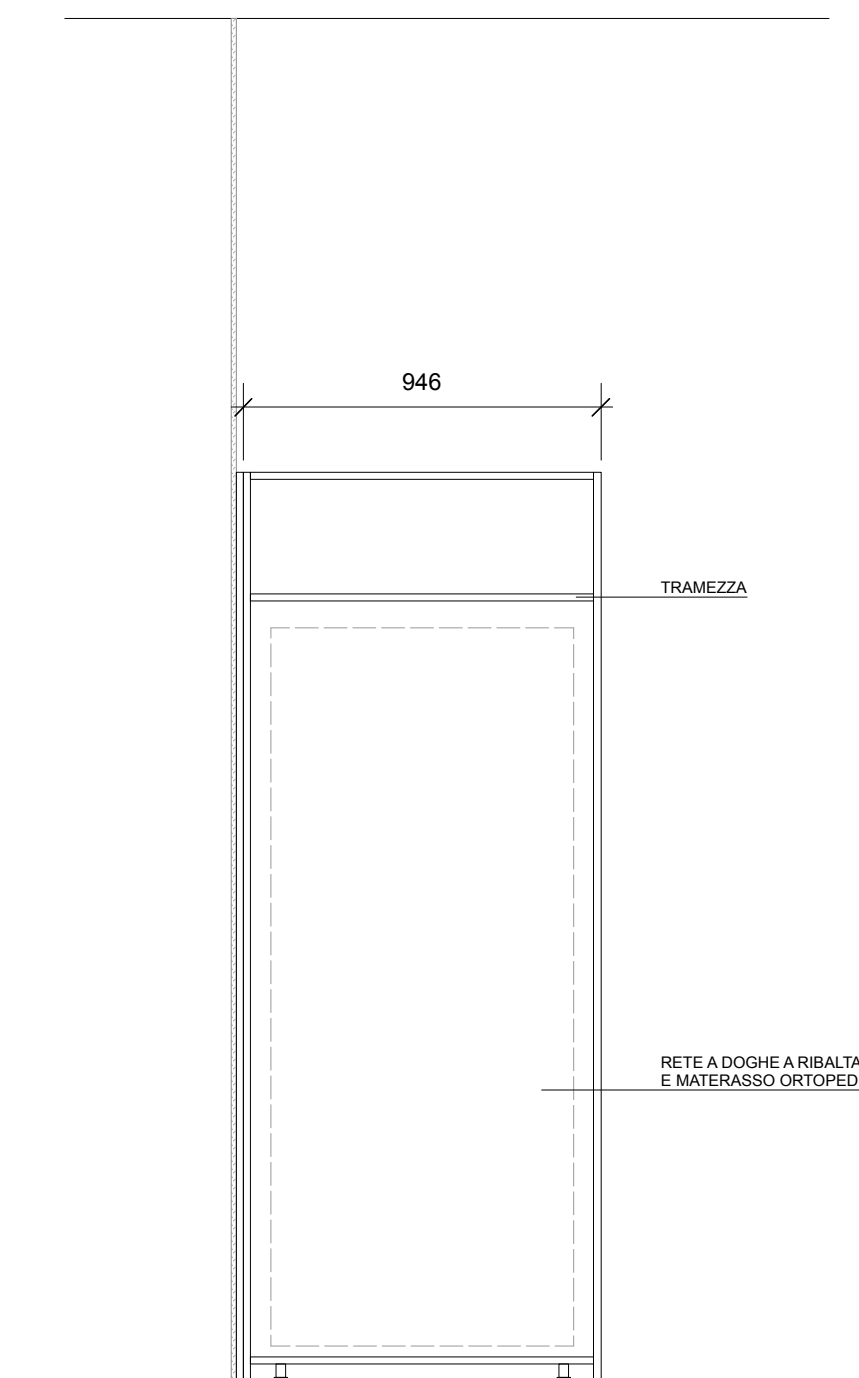
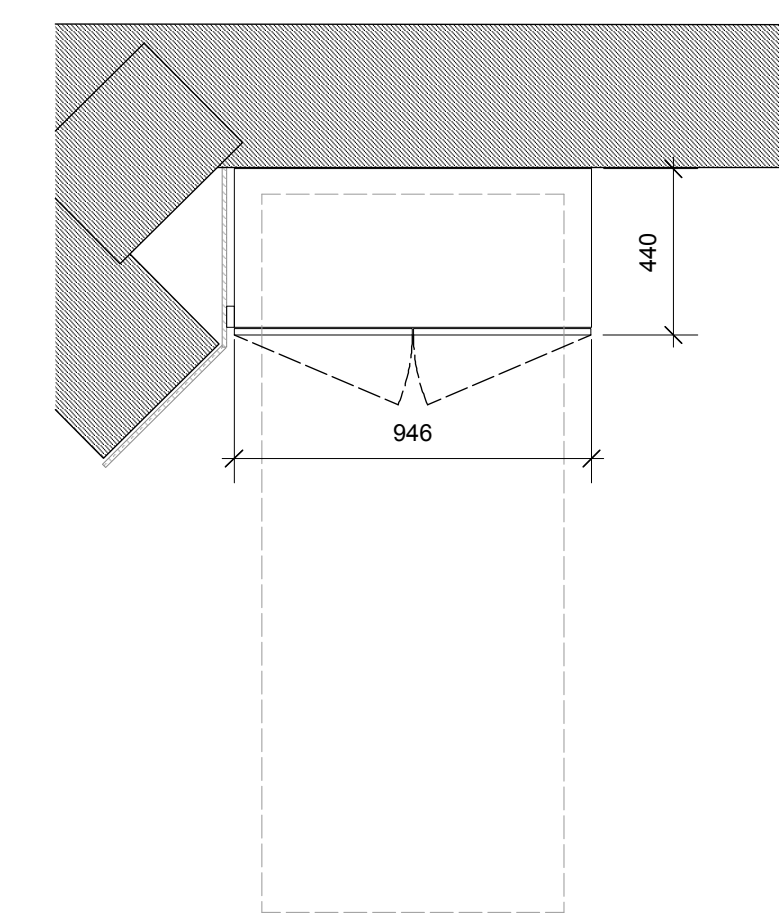
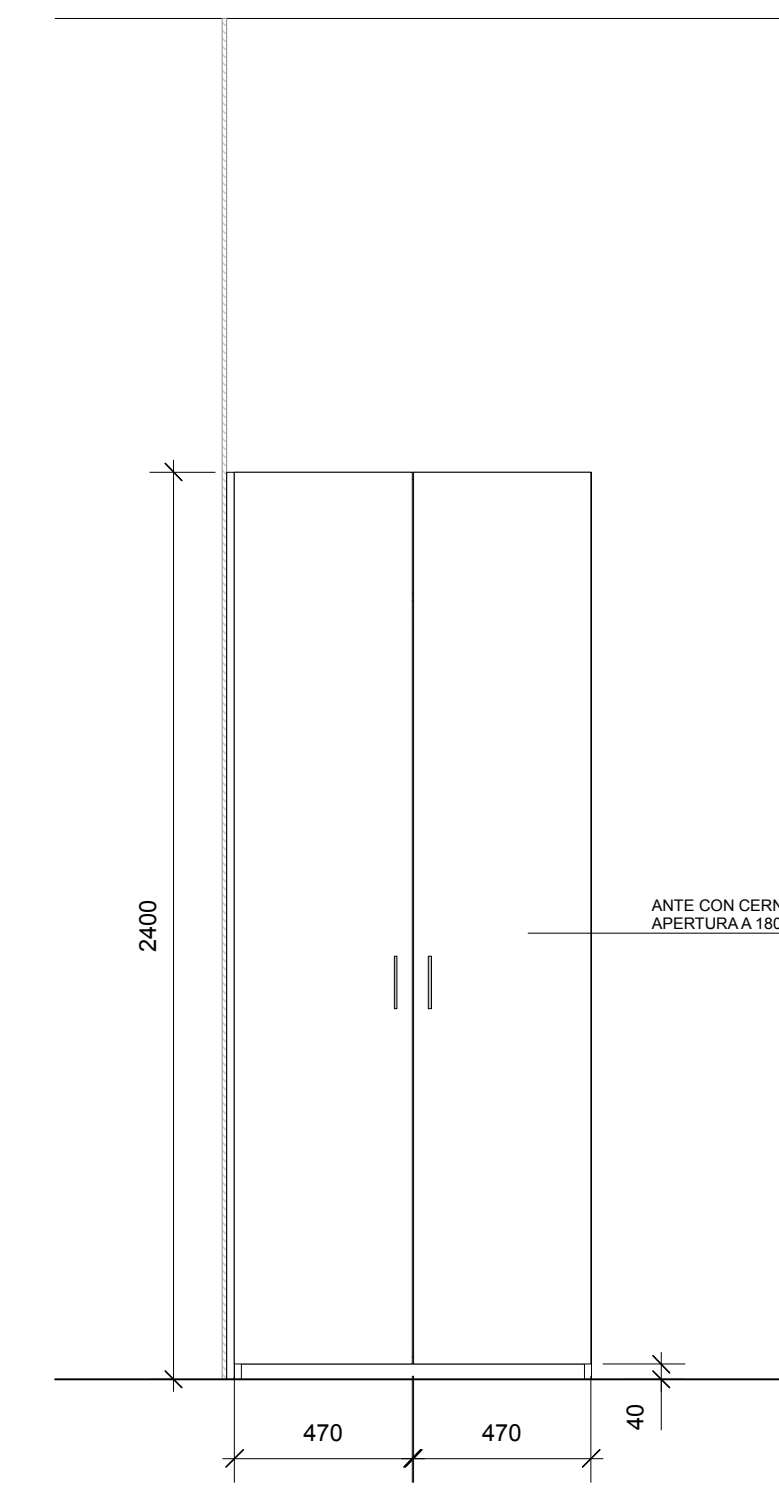

AZIENDA COMUNALE FARMACIE
Azienda Speciale del Comune di San Donato Milanese
Via Unica Belgiano 16 - 20097 San Donato Milanese MI
Responsabile unico del procedimento

FARMACIA COMUNALE SEDE 1

Fornitura e posa in opera di nuovo arredamento su misura farmacia Comunale di piazza Tevere n. 16

PROGETTO DEFINITIVO/ESECUTIVO

Progetto architettonico
studio AZdesign
Via Piemonte, 13 - 24052 Azzano San Paolo (BG) - T/F 035 328314
Collaboratori **Andrea Zanini**
Paolo Pezzotta

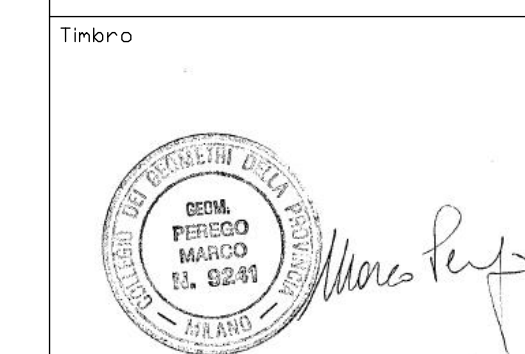

Coordinamento sicurezza **Geom. Marco Perego**

PROGETTO

Oggetto
BOX PROVA, CABINA COSMESI

Scala
1:20

Formato tavola
A1

Pr06

Novembre 2018

MISURE DEFINITIVE DA RILEVARE E VERIFICARE IN CANTIERE